

4

3

2

1

STEP 1.

OPEN YOUR 6" VISE WIDE ENOUGH TO ACCEPT THE DOUBLE VISE CONVERTER (APPROXIMATELY 9 1/2").

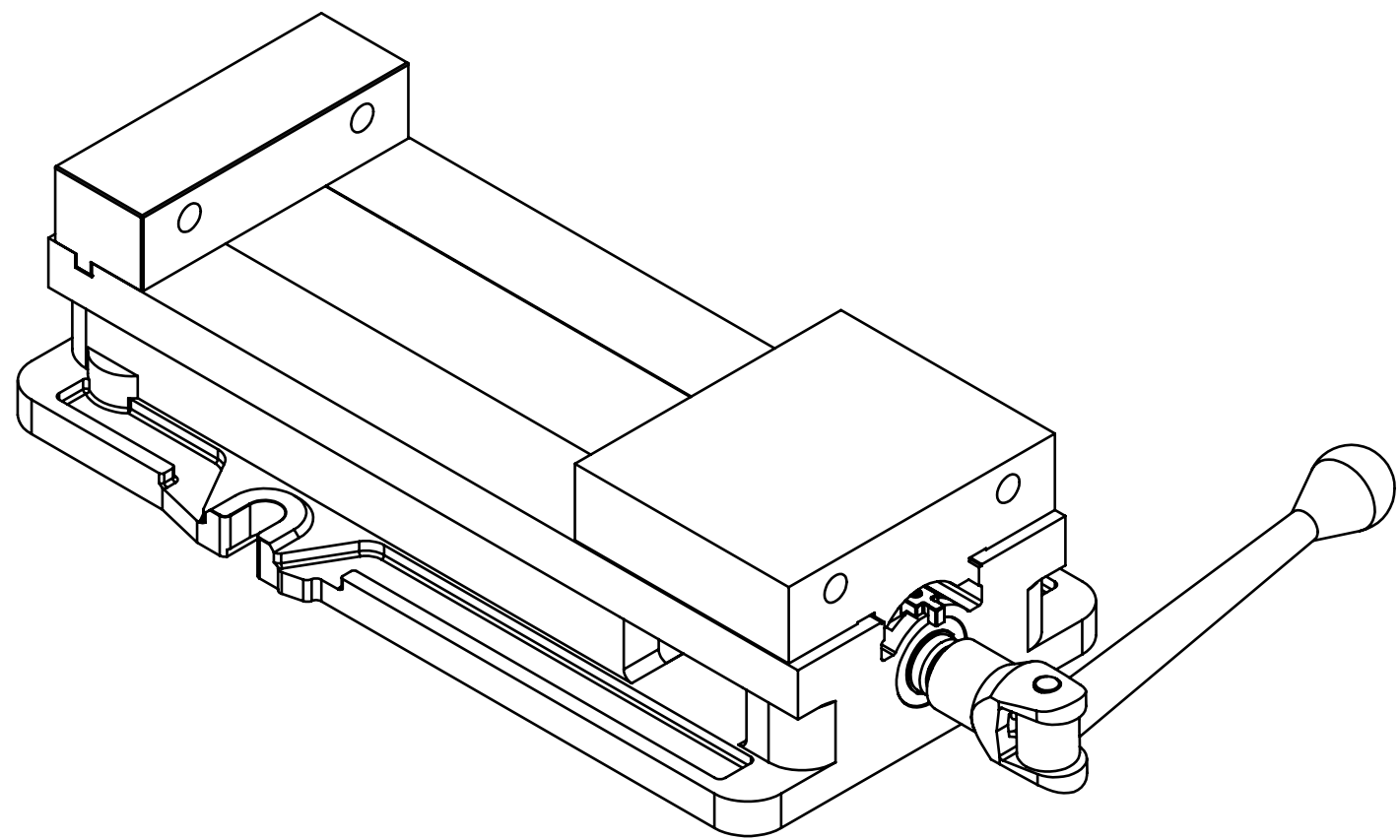

STEP 2.

INSTALL YOUR OUTSIDE SET OF JAWS USING 1/2-13 X 1 1/2 BOLTS.

MAKE SURE NOT TO TIGHTEN THE BOLTS DOWN SO AS TO LEAVE A GAP WIDE ENOUGH TO SLIP THE CONVERTER BETWEEN THE VISE AND THE VISE JAWS ON BOTH SIDES.

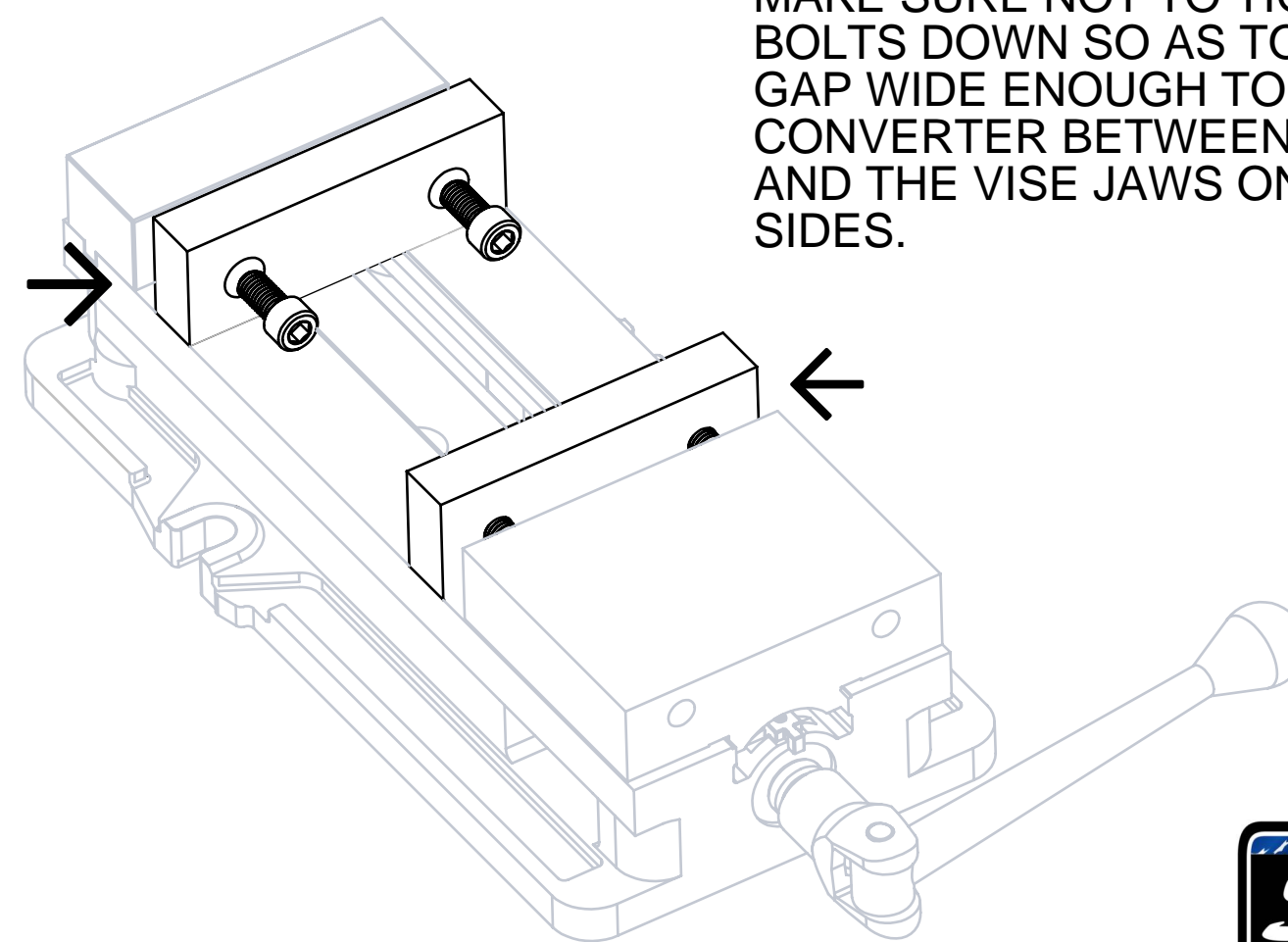

STEP 3.

TIGHTEN ALL (4) 1/2-13 X 1 1/2 BOLTS DOWN TO LOCK THE CONVERTER INTO PLACE

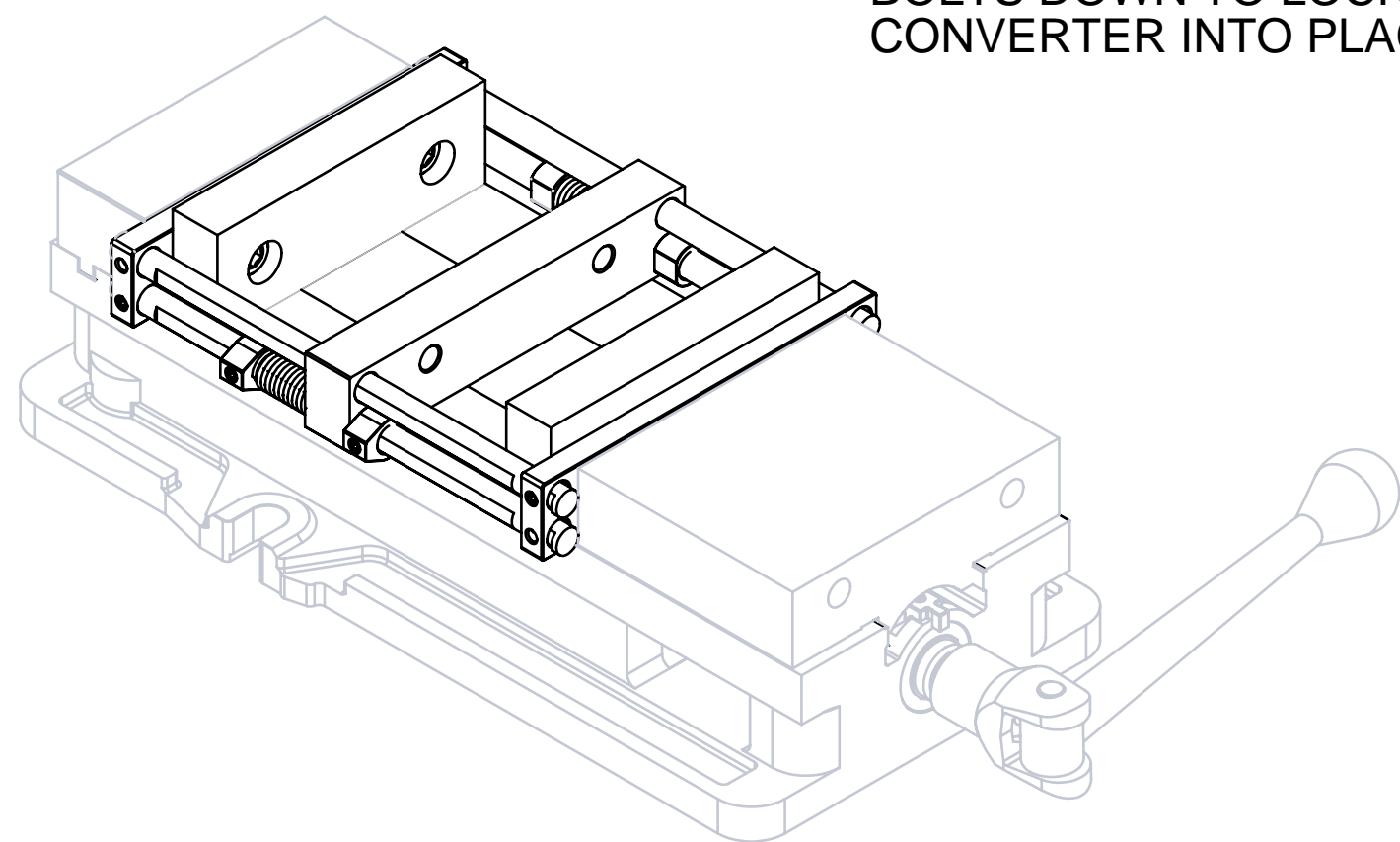

STEP 4.

ADD YOUR SET OF JAWS TO THE CENTER HARD JAW OF THE CONVERTER AND BOLT DOWN WITH 1/2-13 X 3/4 BOLTS (4) PLACES.

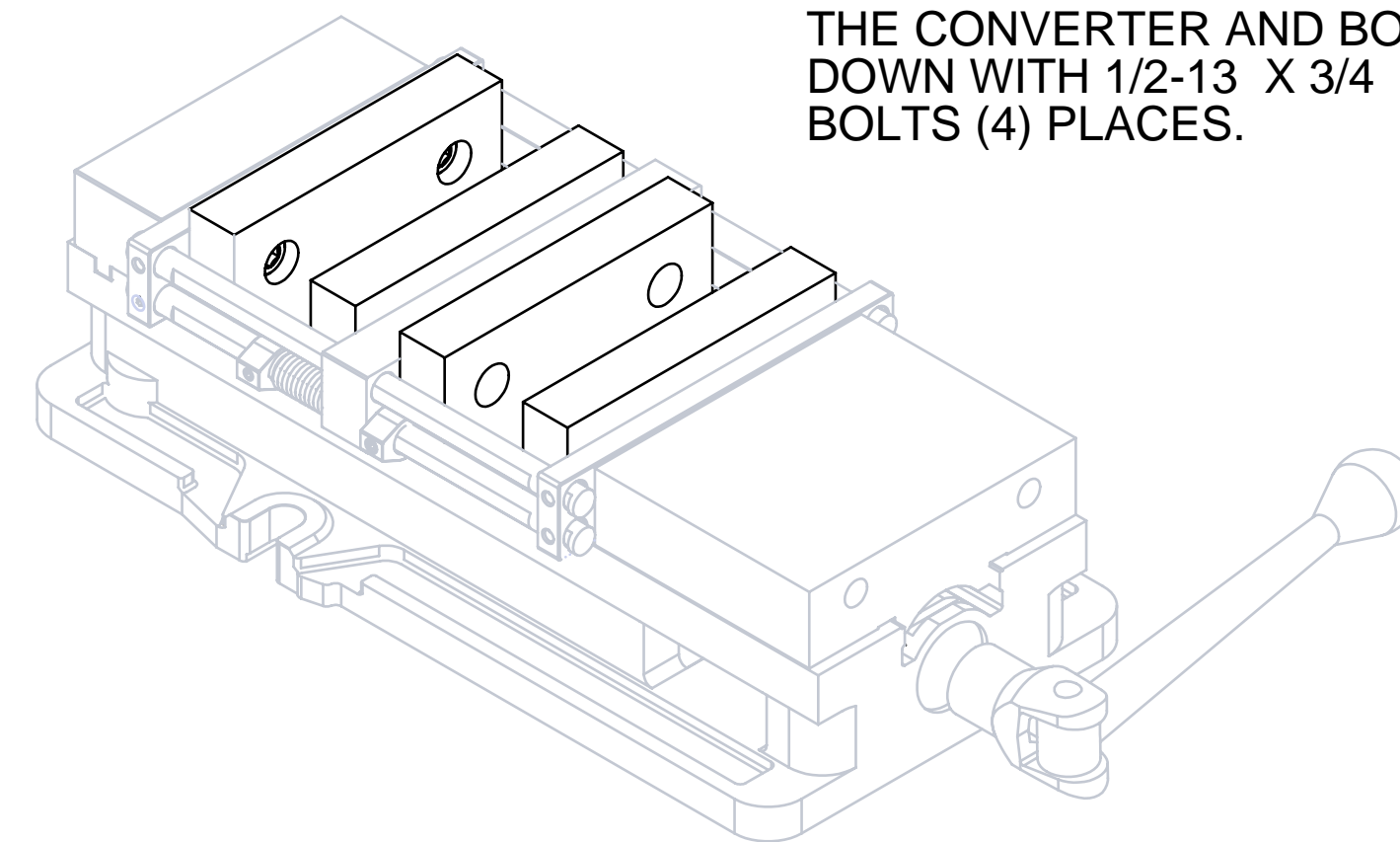

4

3

2

1

4

3

STEP 5.

"Square part"
cut out sample

MACHINE YOUR HARD
OR SOFT JAWS AS
BEFORE TO ACCEPT
THE PART YOU ARE
GOING TO MACHINE.

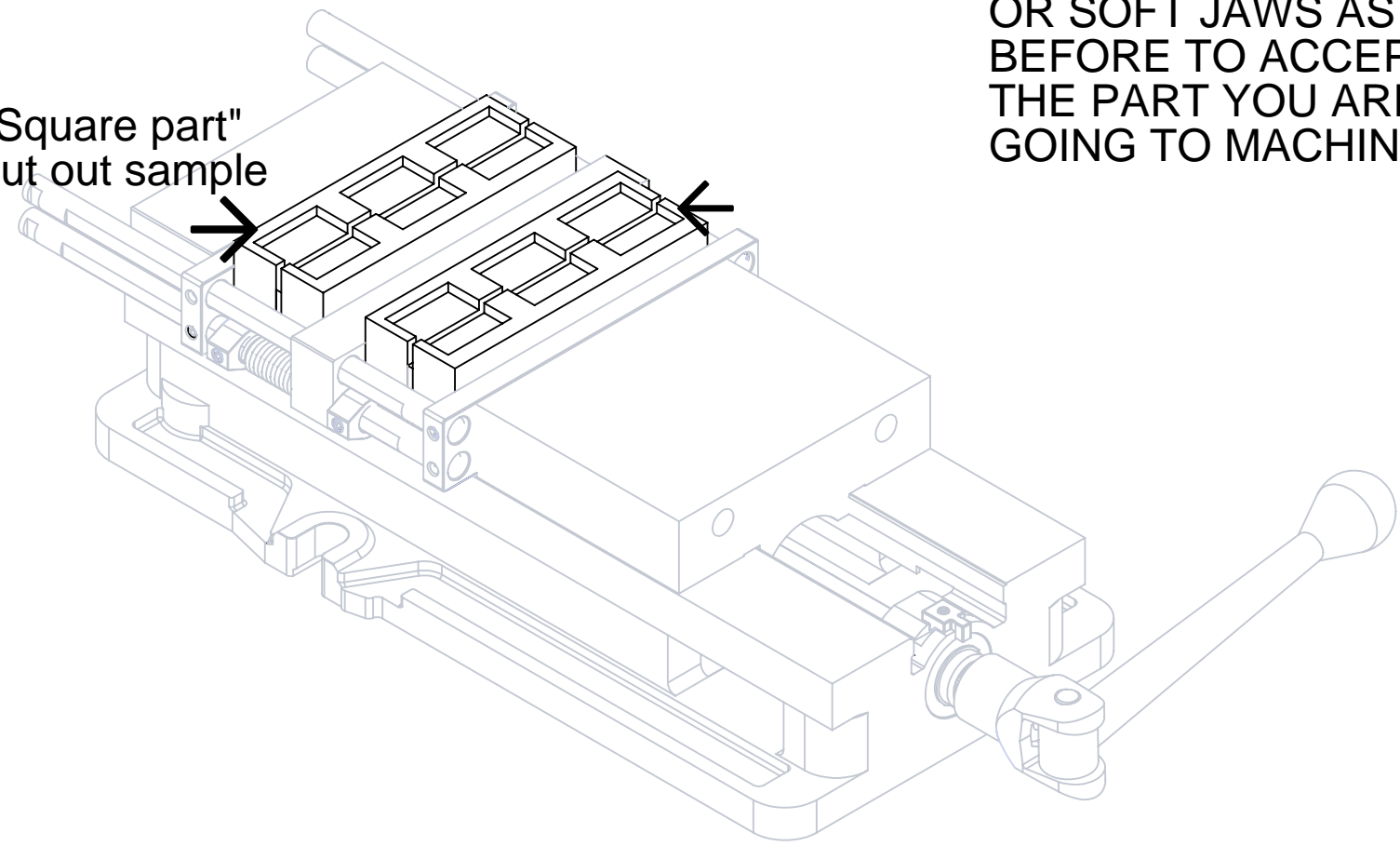

2

1

STEP 6. SETTING THE STOPS ON THE DOUBLE VISE CONVERTER.

STEP 6A.

WITH THE VISE STILL CLOSED, SET THE (2)
SPRING LOADED STOPS FIRST. MAKE SURE TO
PUT TENSION ON THE SPRINGS BY PULLING THE
STOPS TOWARD THE CENTER HARD JAW AND
LEAVING APPROXIMATELY A 3/4" GAP
BETWEEN THE STOP AND THE CENTER HARD JAW. LOCK
DOWN THE SET SCREWS.

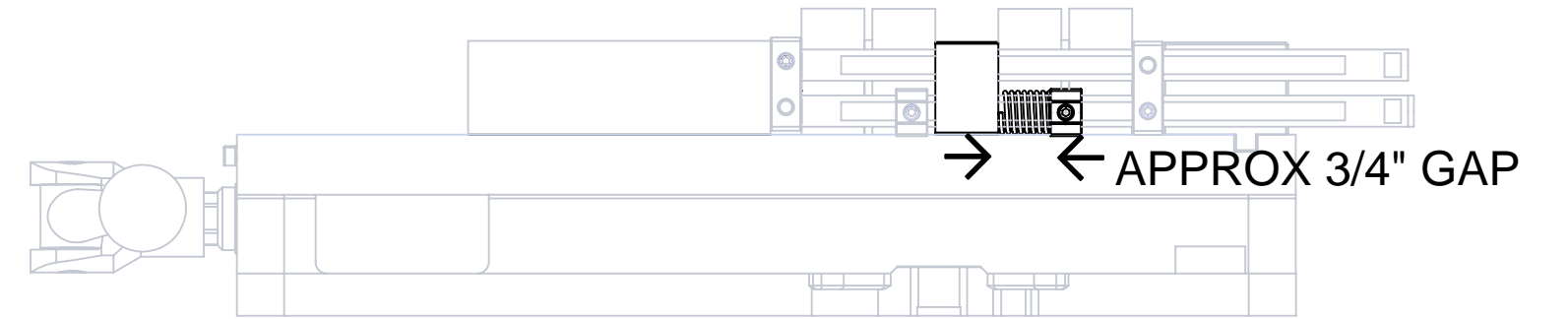

STEP 6B.

SET THE OTHER (2) STOPS BY
LEAVING APPROXIMATELY A 1/8" GAP
BETWEEN THE STOPS AND THE
CENTER HARD JAW. LOCK DOWN THE
SET SCREWS.

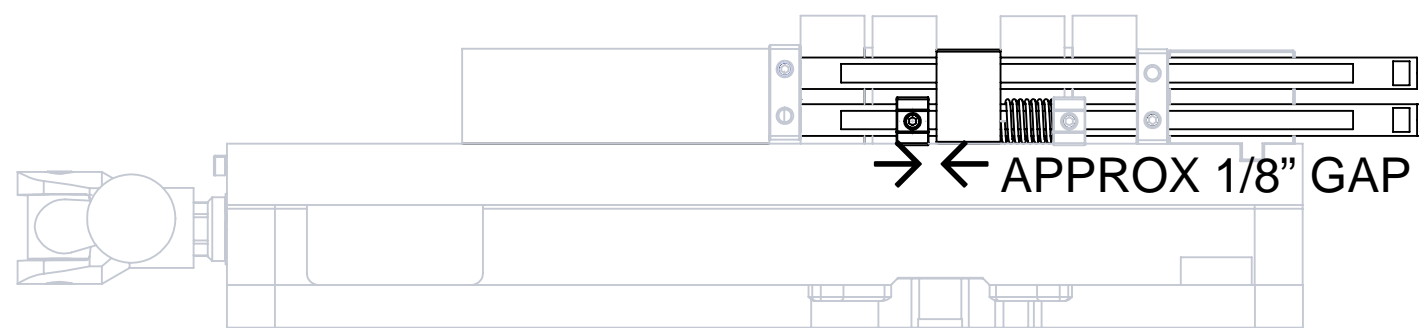

UNCLAMP YOUR
VISE TO RELEASE
YOUR PARTS OR
PARALLELS AND
YOU ARE NOW
READY TO GO!!

STEP 7.

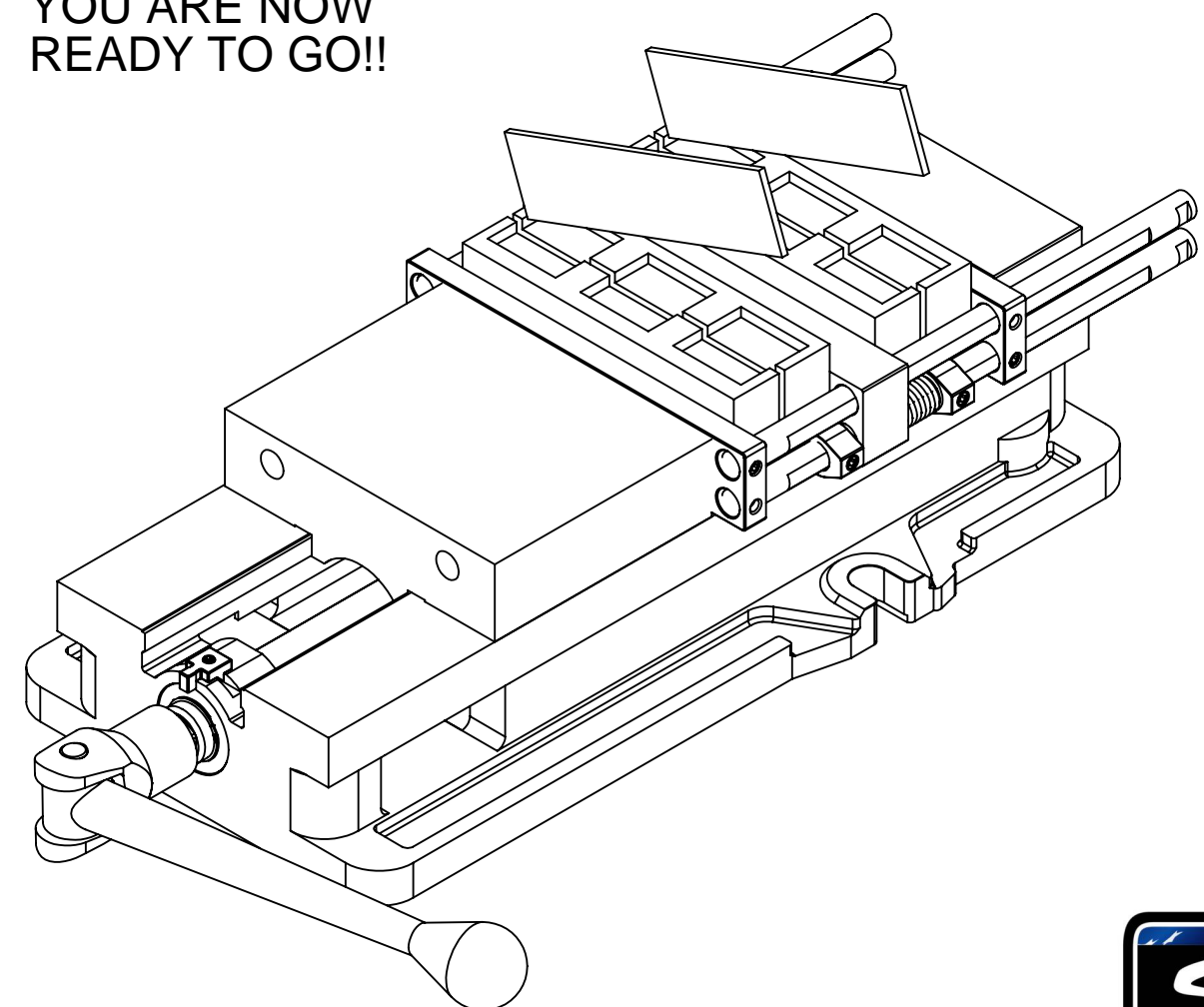

4

3

2

1